

Creative
tip

HANDMADE CLASP

Essentials:

- Aluminum or copper wire
- 1 pair of flat pliers
- 1 pair of round pliers
- 1 pair of cutting pliers

→ Recommended gauge
Copper wire: calibre 18
Aluminum wire: 1.5 mm



Cut 5 cm of your wire.
At one end of the wire,
create a small eyelet
with your round pliers.

1



Right under the eyelet,
press the wire at the
bottom of your round
pliers and form the $\frac{3}{4}$ of
a circle.

2

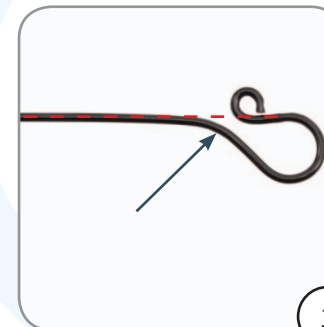

Use your flat pliers to give
your pin an angle so it
finds itself aligned with
the first part of the clip.

3

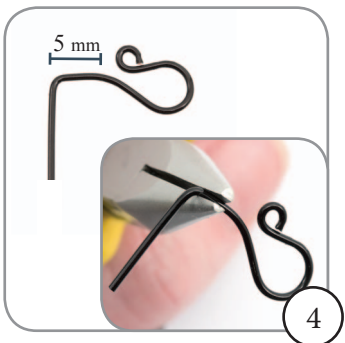

Form a 90° angle to +/-
5 mm from the angle you
made in step 3.

4

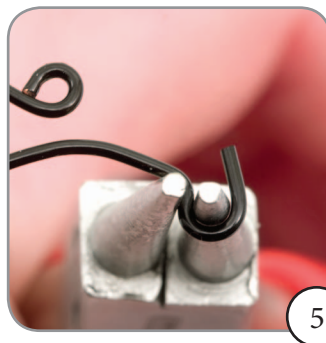

Use your round pliers to
form an eyelet at the
other end of the pin.

5

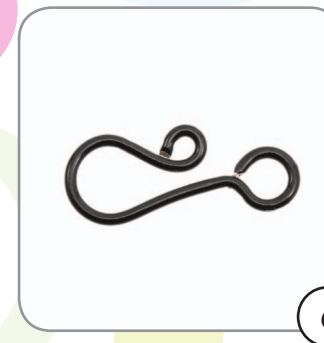

There you go!

6



Online store

www.clubbeadplus.com
info@clubbeadplus.com

Customer service

☎ 514 904-0224 | 1 877 904-0224
📠 514 382-7156 | 1 888 382-7156

Store

185, rue De Louvain Ouest, door 200
Montréal | Québec | H2N 1A3

